

Fishwick are believed to be accurate but they are not guaranteed and do not form a contract. Neither Jordan Fishwick nor the vendor or lessor accept any responsibility in respect of these particulars, which are not intended to be statements or representations of fact and any intending purchaser or lessee must satisfy himself by inspection or otherwise as to the correctness of each of the statements contained in these particulars. Any floorplans on this brochure are for illustrative purposes only and are not necessarily to scale.

TOTAL FLOOR AREA: 721 sq.ft. (67.0 sq.m.) approx.
Measurements are approximate. Not to scale. Illustrative purposes only.
Made with Metropix ©2026

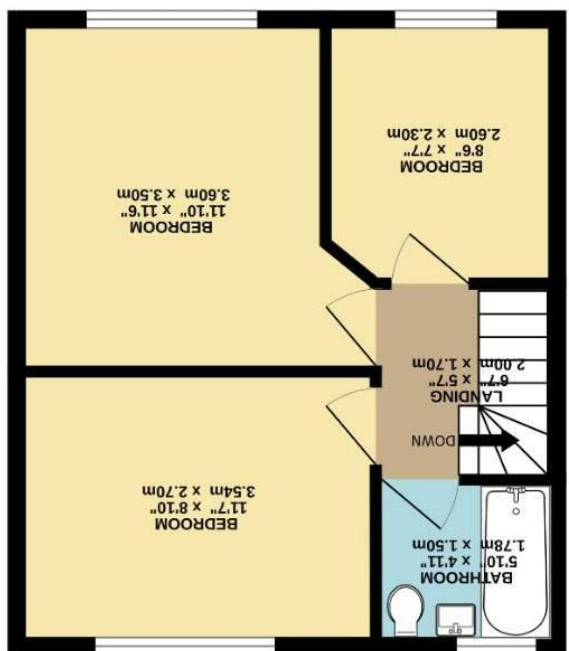

1ST FLOOR
353 sq.ft. (32.8 sq.m.) approx.

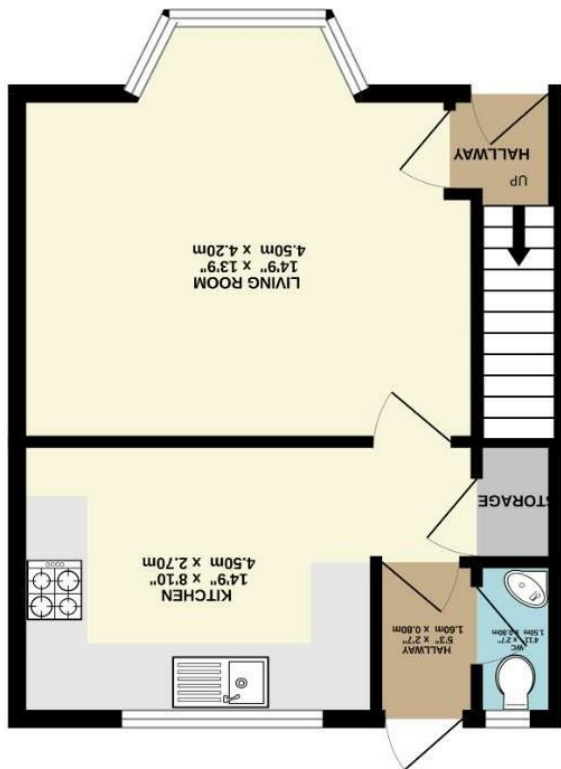

GROUND FLOOR
368 sq.ft. (34.2 sq.m.) approx.



Mersey Crescent, West
Didsbury M20 2ZJ

£335,000



The Property

A traditional semi detached property with spacious living space, good sized gardens, a convenient WEST DIDSBURY location and no onward chain. The accommodation is ready to move into and in outline comprises:- Entrance hall, generous lounge with bay window, fitted kitchen/dining room, downstairs W/C and under stair storage, whilst to the first floor are three good sized bedrooms and a modern bathroom with fitted white suite. Gas central heating and double glazed windows are both in place, whilst to the rear is a good sized rear lawned garden and a driveway offering off-road parking to the front. NO ONWARD CHAIN.

Directions

M20 2ZJ

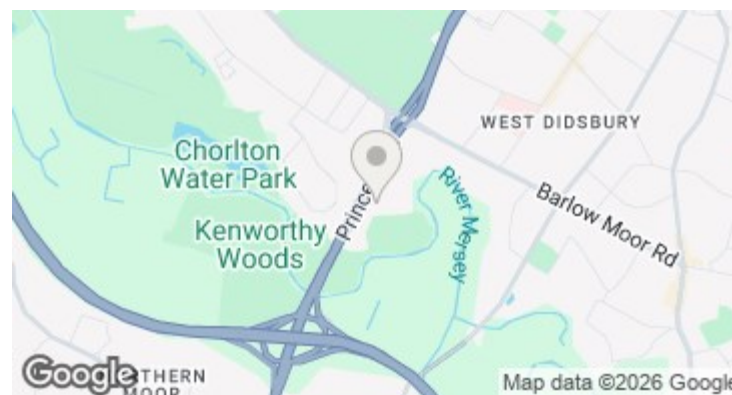

- Traditional semi detached property
- Three good sized bedrooms
- Convenient West Didsbury location
- Off-road parking
- Downstairs W/C
- uPVC double glazing
- Gas central heating
- Generous living room
- Lawned rear garden
- No onward chain

Postcode - M20 2ZJ

EPC Rating - D

Floor Area - 721.00 sq ft

Local Authority - Manchester City Council

Council Tax - A

